



600 Harvest Gate
Lake in the Hills, IL 60156

(847) 960-7440
Fax: (847) 960-7445
www.lith.org

SWIMMING POOL PROCEDURE REQUIREMENTS

Requirements to install a pool in the rear yard:

1. Read the brochure titled “Inspector’s Checklist” for specific requirements.
2. **NOTE:** Only 35% coverage of your lot is permitted. Please make sure the location and size of your pool and deck area is within the allowed setbacks and within the 35% coverage. If you have questions please call 847 960-7440.
2. Please be aware that the pool can be filled no more than 24 inches until the pool has had an approved final inspection and **THE POOL MAY NOT BE USED UNTIL THE POOL PERMIT HAS HAD AN APPROVED FINAL INSPECTION.**
3. Submit a completed application
4. Submit a copy of your Plat of Survey showing the location and size of the pool in the rear yard. **(The survey must show all existing structures)**
(SEE BROCHURE – INFORMATION TO BE SUBMITTED ON YOUR SURVEY)
5. Indicate how your pool will meet the barrier requirements as explained in the “Inspector’s Checklist”. A minimum 4 ft. barrier is required at all times.
Example D on the checklist = Pool will form its own barrier and the ladder must be lockable or removable or a 4 ft. fence with an approved gate will surround the ladder (see gate requirements)
Example E on the checklist = Fenced-in yard will serve as the pool barrier and all doors exiting into the fenced yard will be alarmed per code requirements
6. Proper setbacks and clearances must be indicated on your plans
7. 2009 IECC regulations for pools – IECC 403.9 International Energy Conservation Code
 - . Heated pools require a pool cover on or at the water surface – greater than 90 requires the cover to be minimum R-12
 - . Pool heaters shall be equipped with accessible on-off switch
 - . Time switches for heater schedule shall be installed

8. Electrical requirements are specified in the “Inspector’s Checklist”
These requirements also pertain to hot tubs and spas
9. Your contractor must be licensed by the Village before your permit will be issued.
9. All excess spoils must be removed or relocated in a manor approved by the Community Development Department prior to final inspection.
10. Please allow approximately 5 days after submitting your application, survey and specifications for the review process before the permit will be issued.
11. A FINAL INSPECTION IS REQUIRED FOR YOUR POOL OR SPA PERMIT.
These permits are 2 month permits and will expire at the end of that time. An approved final inspection must be obtained within the 2 month period.

CAUTION: Contact J.U.L.I.E. 48 hours before you dig. 800-892-0123

| |
|--|
| <p>CONSTRUCTION HOURS MONDAY THROUGH SATURDAY – 7:30 AM TO 8:00 PM</p> |
|--|

Cash, checks, payable to the Village of Lake in the Hills and credit cards (Master Card, American Express and Discover) are accepted.

HOMEOWNER IS RESPONSIBLE FOR THIS PERMIT IN ITS ENTIRETY. HOMEOWNER TAKES FULL RESPONSIBILITY FOR DAMAGES INCURRED DURING CONSTRUCTION. THIS INCLUDES DAMAGE TO THE PUBLIC RIGHT-OF-WAY, INCLUDING STREETS, CURBS, SIDEWALKS, DRIVEWAYS AND TREES.



600 Harvest Gate
Lake in the Hills, IL 60156

(847) 960-7440
Fax: (847) 960-7445
www.lith.org

SWIMMING POOL REQUIREMENTS

INSPECTOR'S CHECKLIST

1. 4 FT. Barrier is required
 - A. Pool or Fence is measured from the ground up on the outside of the barrier
 - B. Barrier must completely surround the pool
 1. Max. opening of the fence barrier is 4 inches
 2. Max. opening at the bottom of the fence barrier to the finish grade is 2 inches
 3. Max. opening for a Chain Link Barrier is 1 ¼ inches
 - C. **If the above ground pool serves as its own barrier, the following is required:**
 1. The ladder must be capable of being secured, locked or removed to prevent access
OR
 2. The ladder must be surrounded by a minimum 4 ft. barrier with an approved gate
OR
 3. If there is a deck with stairs – a minimum 4 ft. barrier should be at the bottom of the stairs with an approved gate (See gate requirements)
 - D. **If a fenced-in yard serves as the barrier, the following is required:**
 1. Fence must be minimum 4 ft. high, 30% open and meeting the above barrier requirements
 2. An approved gate must be installed (See gate requirements)
 3. The house becomes part of the barrier
 - a. Approved alarm must be installed on all doors and screens (if present) with access to the pool
2. Clearances: Minimums
 - A. 5 ft. to underground electric
 - B. 10 ft. measured horizontally from the inside of the walls of the pool (overhead)
 - C. 22.5 ft. clearance from power lines in any direction to the water level (overhead)
 - D. 20 ft. from neighbors house
 - E. Minimum of 5 ft. from the rear property line and 4 ft. from the side property line

POOL MAY NOT ENCROACH ONTO ANY EASEMENT

3. Gate requirements:

- A. Must swing outward away from the pool
- B. Be self closing
- C. Be self latching
- D. Latch location as follows:
 - 1. 4 ft. fence – Release mechanism of the latch must be:
 - a. Located on the pool side of the gate
 - b. Located minimum of 3 inches from the top of the gate
 - c. There can be no opening greater than ½” within 18” of the latch
 - 2. 5 ft. or 6 ft. fence – Release mechanism must be minimum 54 inches above grade

4. 2009 IECC requirements – IECC 403.9, International Energy Conservation Code

- 1. Heated pools require a pool cover on or at the water surface – heated greater than 90
Requires the cover to be minimum R-12
- 2. Pool heaters shall be equipped with accessible on-off switch
- 3. Time switches for heater schedule shall be installed

5. Electrical requirements:

- 1. Convenience outlet must be a GFI Outlet 10 ft. to 20 ft. from the pool with a weatherproof cover
- 2. At least one convenience receptacle shall be located a minimum of 5 ft. from and not more than 10 feet from the inside wall of the spa or hot tub.
- 3. Pump motor
 - A. Maximum 3 ft. cord allowed
 - B. Twist lock plug, GFI protected with a weatherproof cover is required
 - C. I.M.C. conduit must be buried a minimum 6 inches underground
 - D. #12 copper ground wire is required
- 4. Switches must be a minimum 5 ft. from the pool
- 5. Light fixtures must be a minimum 5 ft. from the pool or 12 ft. above
- 6. All metal parts must be bonded with a minimum #8 copper wire

6. Pool Heaters

- 1. The gas line must be separated from the electric line by a minimum of 6 inches of fill.
SUBMIT BROCHURE WITH SPECIFICATIONS

CAUTION: Contact J.U.L.I.E. 48 hours before you dig. 800-892-0123

HOMEOWNER IS RESPONSIBLE FOR THIS PERMIT IN ITS ENTIRETY. HOMEOWNER TAKES FULL RESPONSIBILITY FOR DAMAGES INCURRED DURING CONSTRUCTION. THIS INCLUDES DAMAGE TO THE PUBLIC RIGHT-OF-WAY, INCLUDING STREETS, CURBS, SIDEWALKS, DRIVEWAYS AND TREES.



600 Harvest Gate
Lake in the Hills, IL 60156

(847) 960-7440
Fax: (847) 960-7445
www.lith.org

INFORMATION TO BE SUBMITTED ON YOUR SURVEY WHEN APPLYING FOR YOUR POOL PERMIT

Submit your plat of survey indicating the following:

1. Pool location with **dimensions** – (example - 16 ft round, or 12 ft x 18 ft, etc.)
2. Dimensions to the **house**, to the **side property lines**, and to the **rear property line**
3. Location of your overhead or underground utilities
4. Indicate how the pool barrier is being met.
Example D on the checklist – Pool will form its own 48" barrier
OR
Example E on the checklist – Fenced yard will serve as the pool barrier with alarmed doors that are within the fenced area completing the barrier.
5. Submit a picture of the pool
6. Submit information/drawings, including locations and dimensions, for any decks or patios to be included with the pool permit.
7. Submit brochures for any mechanical equipment that will be used.

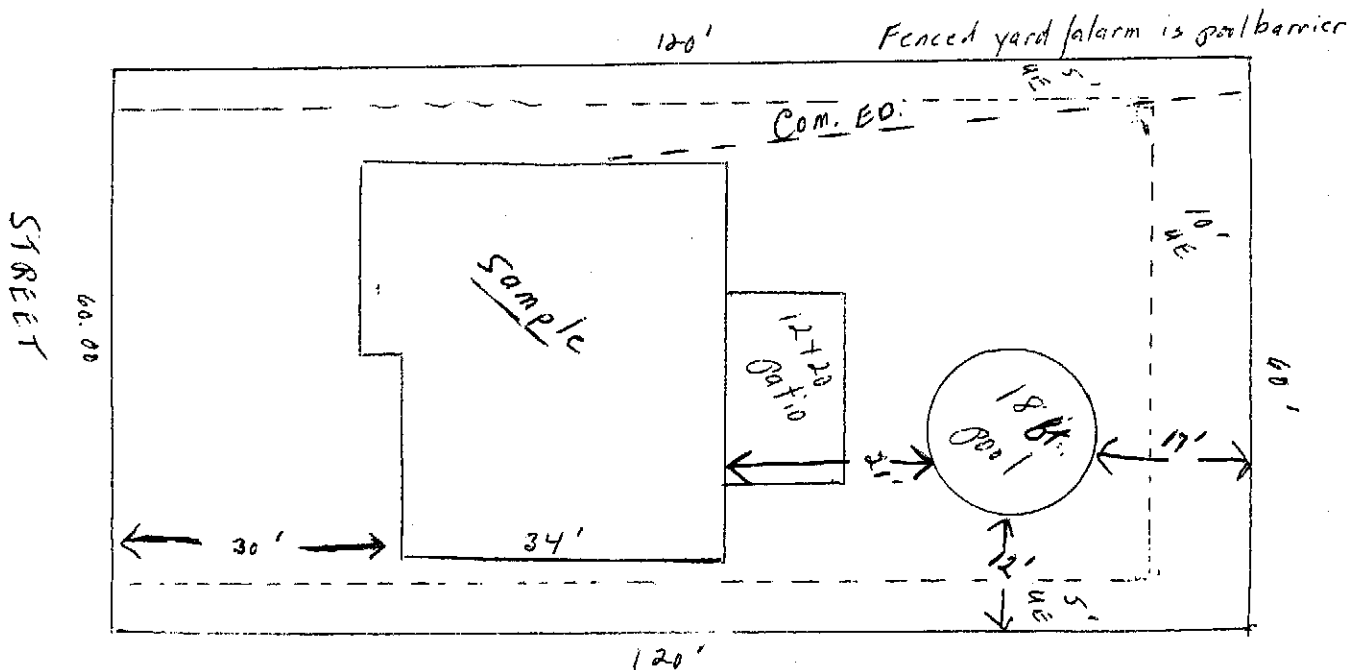

NOTE:
 1. ALL BOXES, COVERS & FITTINGS ARE UL APPROVED OUTDOOR TYPE
 2. AN ALTERNATIVE TO GFCI PROTECTING THE PUMP RECEPTACLE THRU THE CONVENIENCE RECEPTACLE IS THE USE OF A GFCI TYPE CIRCUIT BREAKER IN THE SERVICE PANEL TO PROTECT BOTH THE CONVENIENCE + PUMP RECEPTACLES.

