

SEE SHEET 2 FOR
INDEX OF SHEETS,
GENERAL NOTES,
AND
COMMITMENTS

Project Description:
Proposed residential network buildout



PLANS FOR PROPOSED FIBER INSTALLATION

Market: NWCCHIL

Chassis: NWCCHILMXXK06

Sector: NWCCHIL2102

Bore Footage: 14358

Passings: 231

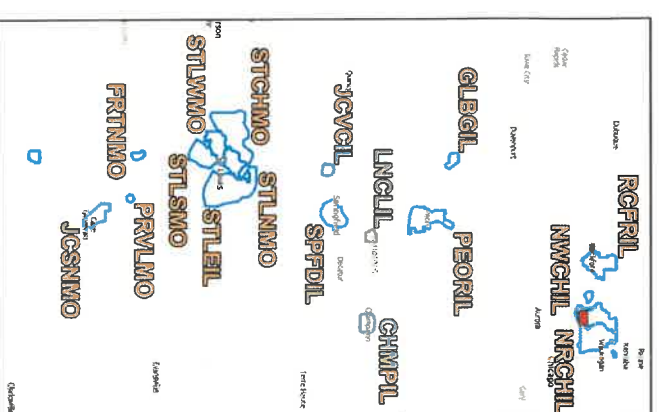

Geographic Information:

State: Illinois

County: McHenry

City: Lake in the Hills

List of Permitting Authorities:

1. City of Lake in the Hills
2. None
3. None
4. None
5. None
6. None

i3Broadband - Engineering Department
PHONE: (309) 670-0400 ext. 400
EMAIL: engineering@i3broadband.com

Project Designer: **Troy Mosiman**
Const. Manager: **Laurie Macdonald**
Market Manager: **Coty Keosprasa**

811 FOR LOCATING SERVICES
CALL: (800) 892-0123 (IL)
(800) 344-7483 (MO)
or 811 (US)



Printed: 1/21/2025
Time: 12:55 PM

**SUBMITTED
FOR PERMITTING**

INDEX OF SHEETS

CI	Cover Sheet
MI	Index, General Notes, and Commitments Sheet
DT1	Typical Vault Details Sheet
DT2	Typical Vault Installation Details Sheet
LI	Symbol Reference Legend Sheet
PO1	Project Overview Map
DI - D11	Duct and Vault Installation Maps
FI - F11	Fiber Installation Maps
DOT Highway Standards	Offered Operators, 24, 2M More Than 15ft Away
70100-102	Offered Operators, 24, 2M, 15ft to 24ft from Pavement Edge
70100-05	Offered Operators, 24, 2M, 15ft to 24ft from Pavement Edge
70100-09	Traffic Control Devices

SPECIAL PERMITTING COMMITMENTS

GENERAL PLAN NOTES

- These notes shall be applicable to all operations performed under this contract, except when they conflict with any SPECIAL PERMIT COMMITMENTS (SEE THIS SHEET). In such cases, the notes in that section shall supercede these notes.
- All care should be taken to mitigate damage to existing utilities. OneCall shall be contacted before any boring or excavation.
- Note that handholes drawn on the shared lot line can be adjusted to either side of the lot line as necessary, which is standard on 13Broadband prints. Handholes that are shifted to one side of a lot line need to be placed on that side of the lot line, generally to comply with an easement, or to avoid a driveway or large tree.
- Construction change order requests shall be coordinated with the appropriate 13 Construction Department Representative and CLEARLY DOCUMENTED ON THESE PLANS AS RED-LINED AS-BUILT DRAWINGS.
- Any damage to adjacent properties caused by construction operations within the work area shall be fully restored to their ORIGINAL CONDITION.
- Dimensions (approximate, in feet) shown generally indicate total Right-of-Way width, or Utility Easement width relative to nearest lot line. Rights-of-Way and Utility Easements are not necessarily uniform (i.e. not split evenly a cross street centerline or property line). Contact 13 as needed for clarity.
- SLACK NOTES:
-All taps are to have 4' of slack at the head, 55' at the splice case, and no slack storage anywhere else.
-Mainline cable to have 55' at all ends/cut points and 110' at all #3 or larger handholes where cable is uncut.
-Any other abnormalities will be noted on prints.
The CONTRACTOR shall be required to comply with all Federal, State, and Local laws/ordinances, in addition to all 13Broadband contract documents.

**SUBMITTED
FOR PERMITTING**



602 High Point Lane
East Peoria, Illinois
(309) 570-0400 ext. 400
13broadband.com

RESERVED
FOR SHEET
NORTH ARROW
AND SCALE

PROJECT ENGINEER:
Seven Berthold

REVISIONS
/ 24 No. _____
/ 24 No. _____
/ 24 No. _____
/ 24 No. _____
/ 24 No. _____

PROPOSED FIBER INSTALLATION PLANS

INDEX, GENERAL NOTES, AND COMMITMENTS

SECTOR: NWCHIL2.102

Printed: 1/21/2025
Time: 1:51 PM

SHEET:

N1

SYMBOL REFERENCE LEGEND

CONSTRUCTION

- Duct/Conduit**
 - Primary
 - Secondary
 - Third Order
 - Fourth Order
 - In Building
- Shelters**
 - Type A
 - Type B
 - Type C
 - Type D (No Grounding)
- Solters**
 - Class
 - Zone
 - Unknown
- Internal Taps**
 - 2 Pairs
 - 4 Pairs
 - 6 Pairs
 - 8 Pairs
 - 12 Pairs
- Valves/Handholes**
 - Unknown Size (Precedent)
 - HH 0 (12x12 or eq.)
 - HH 1 (12x14 or eq.)
 - HH 2 (12x20 or eq.)
 - HH 3 (12x30 or eq.)
 - HH 6 (24x or eq.)
 - HH 12 (24x or eq.)
 - Unknown Size (See Notes)
- Pedestrian Rated**
 - Unknown Size (Precedent)
 - HH 0 (12x12 or eq.)
 - HH 1 (12x14 or eq.)
 - HH 2 (12x20 or eq.)
 - HH 3 (12x30 or eq.)
 - HH 6 (24x or eq.)
 - HH 12 (24x or eq.)
 - Unknown Size (See Notes)
- Additional Cable Slack**
 - Additional Cable Slack
- Taps**
 - 2 Pairs
 - 4 Pairs
 - 6 Pairs
 - 8 Pairs
 - 12 Pairs
- Unknown/Other**
 - Unknown
- Building Terminations (OPFCs)**
 - Building Terminations (OPFC)
- Cable Terminations**
 - Cable Terminations
- Duct Terminations**
 - Buried Endless
 - Stubbed Above Ground (Bdg. Termination)
 - Wall Box
 - Open/Unknown

INSTALLED

- Shelters**
 - Shelters
- Cabinets**
 - Cabinets
- Valves/Handholes**
 - Unknown Size (Precedent)
 - HH 0 (12x12 or eq.)
 - HH 1 (12x14 or eq.)
 - HH 2 (12x20 or eq.)
 - HH 3 (12x30 or eq.)
 - HH 6 (24x or eq.)
 - HH 12 (24x or eq.)
 - Unknown Size (See Notes)
- Pedestrian Rated**
 - Unknown Size (Precedent)
 - HH 0 (12x12 or eq.)
 - HH 1 (12x14 or eq.)
 - HH 2 (12x20 or eq.)
 - HH 3 (12x30 or eq.)
 - HH 6 (24x or eq.)
 - HH 12 (24x or eq.)
 - Unknown Size (See Notes)
- Additional Cable Slack**
 - Additional Cable Slack
- Taps**
 - 2 Pairs
 - 4 Pairs
 - 6 Pairs
 - 8 Pairs
 - 12 Pairs
- Unknown/Other**
 - Unknown
- Third Party Valves/Handholes**
 - Third Party Valves/Handholes
- Fiber Manholes**
 - AT&T Manhole
 - Fiber Optic Manhole
- Building Terminations (OPFCs)**
 - Building Terminations (OPFC)
- Cable Terminations**
 - Cable Terminations
- Duct Terminations**
 - Buried Endless
 - Stubbed Above Ground (Bdg. Termination)
 - Wall Box
 - Open/Unknown
- Duct Field Repairs**
 - Duct Field Repairs

MISC.

- Utility Easement**
 - Utility Easement
- Parcel**
 - Duct and Valve Transition Plans
 - Fiber Installation Plans
- Sector Boundaries**
 - Color & Index Map (Project)
 - Index Map (All)
- Project Scale**
 - Project Scale
- Non-Project Sectors**
 - Non-Project Sectors
- DPO Arrows**
 - DPO Arrows
 - Drop Arrow (Outside)
- Index Sheet Borders**
 - Project Sheet Borders
- Duct/Conduit**
 - Order
 - Primary
 - Secondary
 - Fourth Order
 - In Building

SUBMITTED
FOR PERMITTING

Sheet Path: C:\Users\StevenBentham\Documents\Completed Sector Projects\NWCHIL2102\DWG\Project_01_Templates

Broadband
602 High Point Lane
East Peoria, Illinois
(309) 670-0400 ext. 400
l3broadband.com

RESERVED
FOR SHEET
NORTH ARROW
AND SCALE

PROJECT ENGINEER:
Steven Berthold

REVISIONS
/ 124 No. _____
/ 124 No. _____
/ 124 No. _____
/ 124 No. _____

Printed: 1/21/2025
Time: 1:24 PM

PROPOSED FIBER INSTALLATION PLANS
SYMBOL REFERENCE LEGEND
SECTOR: NWCHIL2102

SHEET:
L1

Facilities leaving project boundaries shown only for reference. Only facilities entirely inside of project boundaries to be considered part of the project scope unless otherwise specified.



Project Path: C:\Users\jshen\Documents\Projects\NWCHIL2102\NWCHIL2102_Sector\NWCHIL2102_Sector.dwg

13 Broadband
 502 High Point Lane
 East Peoria, Illinois
 (309) 670-4400 ext. 400
 [ibroadband.com]



SCALE: 1" = 50 FEET

SHEET NO. 123

- NOTES:
1. See Sheet 122 for typical road crossing over fiber details.
 2. Method of conduit installation shall be determined by the contractor in accordance with the applicable local, state, and federal regulations and the applicable utility company's (e.g., AT&T, Verizon, etc.) specifications.
 3. Address, conduit, manholes, etc. shall be shown as they exist. Additional items shall show the area of general ownership as the primary duct.

PROJECT ENGINEER:
 Troy Mosman

REVISIONS	
/ 124 No. _____	
/ 124 No. _____	
/ 124 No. _____	
/ 124 No. _____	

PROPOSED FIBER INSTALLATION PLANS

FIBER INSTALLATION PLAN MAPS

Printed: 1/21/2025
 Time: 12:58 PM

SECTOR: NWCHIL2102

D3

SHEET:

Facilities leaving project boundaries shown only for reference. Only facilities entirely inside of project boundaries to be considered part of the project scope unless otherwise specified.



SUBMITTED FOR PERMITTING

502 High Point Lane
East Peoria, Illinois
(309) 670-0400 ext. 400
ibroadband.com

Scale: 1" = 50' Feet
PSS: USA Customary Unit/Standard Coors.

- SHEET NOTES:**
- Fiber routes and sizes are shown as they are proposed. All fiber shall be installed in accordance with applicable codes and standards.
 - Contractor shall verify all dimensions prior to installing fiber cable.
 - See Sheet #1 for finished fiber cable side and return paths.

PROJECT ENGINEER:
Troy Moorman

REVISIONS

1	/ 24 No.
2	/ 24 No.
3	/ 24 No.

PROPOSED FIBER INSTALLATION PLANS

FIBER INSTALLATION PLAN MAPS

Printed: 1/21/2025
Time: 1:00 PM

SECTOR: NWCHIL2102

SHEET: **F1**

Facilities leaving project boundaries shown only for reference. Only facilities entirely inside of project boundaries to be considered part of the project scope unless otherwise specified.



SUBMITTED FOR PERMITTING

DWG PATH: C:\Users\jgwendolm\Documents\Project\NWCHIL2102\DWG\Sheet\F22_Broadband.dwg

602 High Point Lane
East Peoria, Illinois
(309) 670-0600 ext. 400
lbroadband.com

SCALE: 1" = 50 FEET
PCS USA Commercial Equipment Check

- SHEET NOTES:**
1. Fiber cables and duct are shown as they are installed. All other facilities shown are for reference only. Fiber shall be installed within proposed conduit.
 2. Conduit shall have 1/2" wall at termination and 3/4" wall elsewhere.
 3. See Sheet N1 for installed fiber cable data requirements.

PROJECT ENGINEER:
Toy Hochman

REVISIONS
1 / 24 No. _____
1 / 24 No. _____
1 / 24 No. _____

PROPOSED FIBER INSTALLATION PLANS

FIBER INSTALLATION PLAN MAPS

SECTOR: NWCHIL2102

Printed: 1/21/2025
Time: 1:01 PM

SHEET: **F2**

Facilities leaving project boundaries shown only for reference. Only facilities entirely inside of project boundaries to be considered part of the project scope unless otherwise specified.

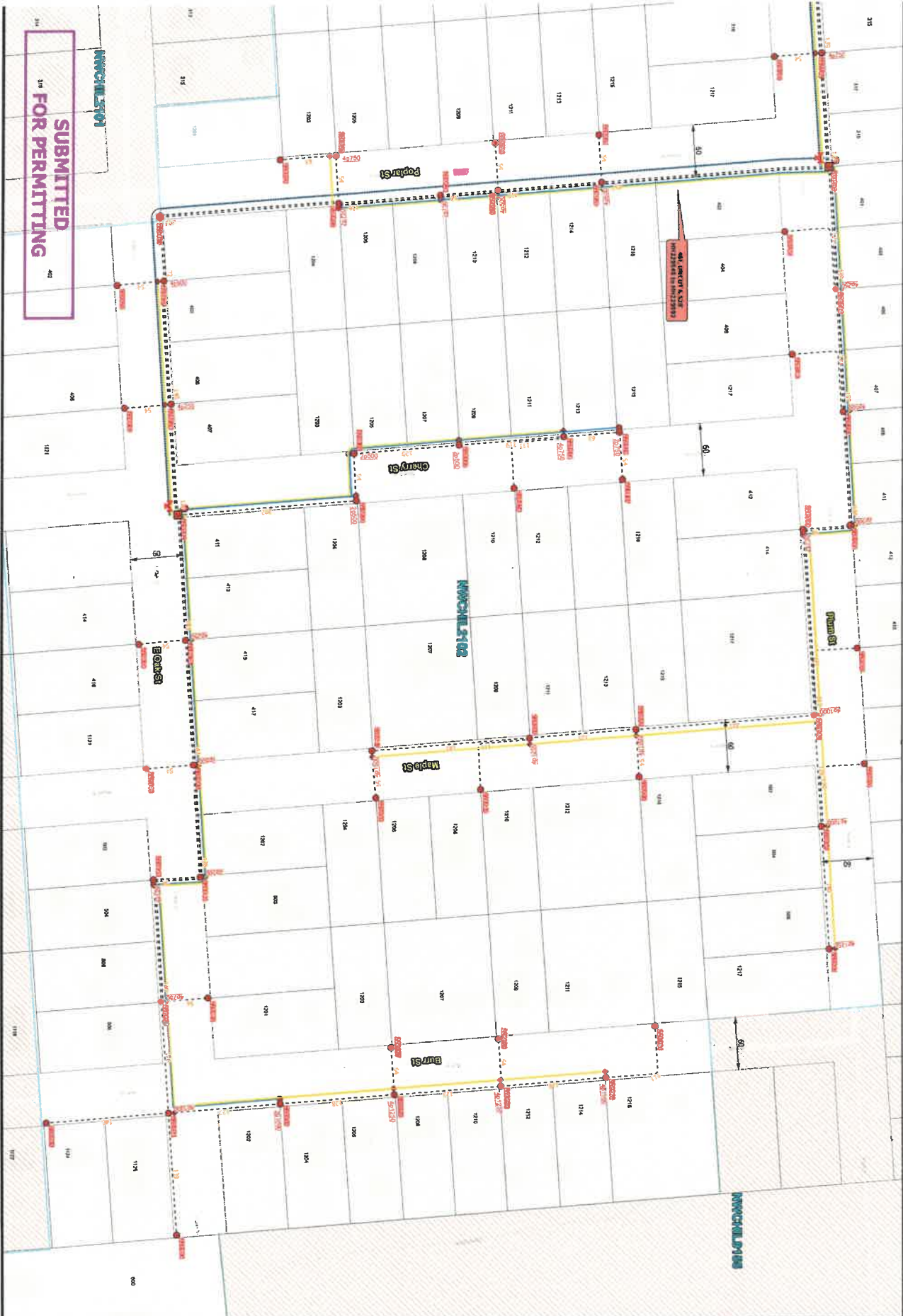

i3 Broadband
 602 High Point Lane
 East Peoria, Illinois
 (309) 670-0400 ext. 400
 Ibroadband.com

SCALE: 1"=50 FEET
 PDS USA Continuous Expansion Curve
 SHEET NOTES:
 1. Fiber cables and splices are shown in black.
 2. Manholes are shown in red.
 3. Right of Way (ROW) lines are shown in red.
 4. All fiber cables and splices shall be installed within proposed conduit.
 5. Conduit shall face north at all manholes prior to installing fiber cable.
 6. See Sheet M1 for included fiber cable backhaul network.

PROJECT ENGINEER:
 Troy Mosiman

REVISIONS
1 / 24 No. _____
1 / 24 No. _____
1 / 24 No. _____
1 / 24 No. _____

PROPOSED FIBER INSTALLATION PLANS
FIBER INSTALLATION PLAN MAPS
 SECTOR: NWCHIL2102
 Printed: 1/21/2025
 Time: 1:01 PM

F3