

SEE SHEET 2 FOR
INDEX OF SHEETS,
GENERAL NOTES,
AND
COMMITMENTS

Project Description:
Residential fiber buildout

Geographic Information:

State: Illinois
County: McHenry
City: Lake in the Hills

List of Permitting Authorities:

1. Village of Lake in the Hills
2. None
3. None
4. None
5. None
6. None

i3Broadband - Engineering Department
PHONE: (309) 670-0400 ext. 400
EMAIL: engineering@i3broadband.com

Project Designer: **Steven Berchtold**
Const. Manager: **Nemanja Stanojevic**
Market Manager: **Coty Keoprasa**

811
FOR LOCATING SERVICES
CALL: (800) 892-0123 (IL)
(800) 344-7483 (MO)
or 811 (US)

Printed: 4/10/2025
Time: 12:37 PM

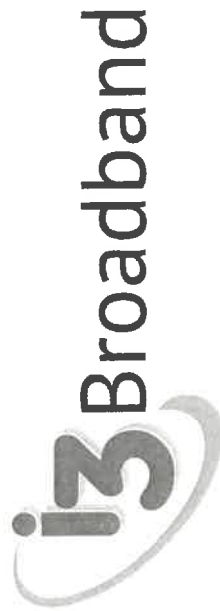

PLANS FOR PROPOSED FIBER INSTALLATION

Market: NWCHIL
Chassis: NWCHILMXKC03
Sector: NWCHIL2045
Bore Footage: 11675
Passings: 234

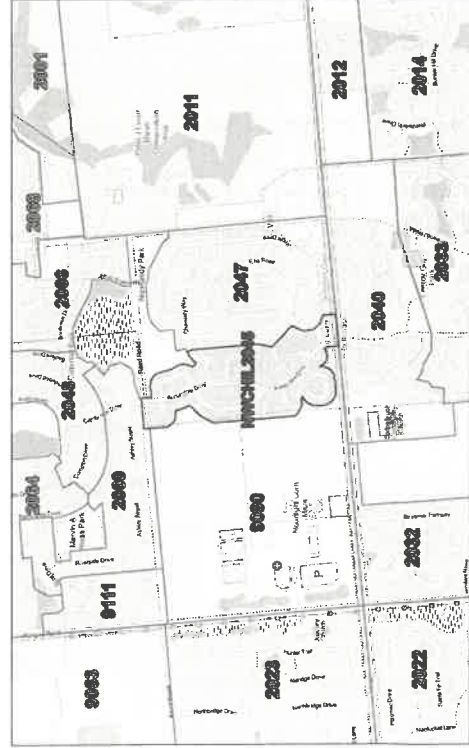
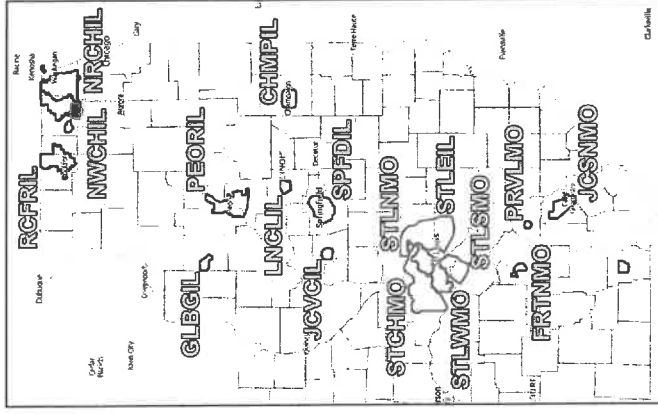

**SUBMITTED
FOR PERMITTING**

INDEX OF SHEETS

CI	Cover Sheet
NI	Index, General Notes, and Commitments Sheet
DT1	Typical Vault Details Sheet
DT2	Typical Vault Installation Details Sheet
LI	Symbol Reference Legend Sheet
PO1	Project Overview Map
D1 - D3	Duct and Vault Installation Maps
F1 - F3	Fiber Installation Maps

SPECIAL PERMITTING COMMITMENTS

Lake in the Hills
No specific requirements.

GENERAL PLAN NOTES

1. These notes shall be applicable to all operations performed under this contract, except when they conflict with any **SPECIAL PERMIT COMMITMENTS** (SEE THIS SHEET). In such cases, the notes in that section shall supercede these notes.
2. All care should be taken to mitigate damage to existing utilities. OneCall shall be contacted before any boring or excavation.
3. Note that handholes drawn on the shared lot line can be adjusted to either side of the lot line as necessary, which is standard on i3Broadband prints. Handholes that are shifted to one side of a lot line need to be placed on that side of the lot line, generally to comply with an easement, or to avoid a driveway or large tree.
4. Construction change order requests shall be coordinated with the appropriate i3 Construction Department Representative and **CLEARLY DOCUMENTED ON THESE PLANS AS RED-LINED AS-BUILT DRAWINGS**.
5. Any damage to adjacent properties caused by construction operations within the work area shall be fully restored to their **ORIGINAL CONDITION**.
6. Dimensions (approximate, in feet) shown generally indicate total Right-of-Way width, or Utility Easement width relative to nearest lot line. Rights-of-Way and Utility Easements are not necessarily uniform (i.e. not split evenly a cross street centerline or property line). Contact i3 as needed for clarity.
7. **SLACK NOTES:**
 - All taps are to have 4' of slack at the head, 55' at the splice case, and no slack storage anywhere else.
 - Mainline cable to have 55' at all ends/cut points and 110' at all #3 or larger handholes where cable is uncut.
 - Any other abnormalities will be noted on prints.
8. The **CONTRACTOR** shall be required to comply with all Federal, State, and Local laws/ordinances, in addition to all i3Broadband contract documents.

**SUBMITTED
FOR PERMITTING**

RESERVED
FOR SHEET
NORTH ARROW
AND SCALE

PROJECT ENGINEER:

Steven Berthold

REVISIONS

/ /24 | No. _____

/ /24 | No. _____

/ /24 | No. _____

/ /24 | No. _____

/ /24 | No. _____

PROPOSED FIBER INSTALLATION PLANS

INDEX, GENERAL NOTES, AND COMMITMENTS

Printed: 4/10/2025
Time: 12:42 PM

SECTOR: NWCHIL2045

SHEET:

N1

SYMBOL REFERENCE LEGEND

CONSTRUCTION

- Duct/Conduit**
- Primary
 - Secondary
 - Third Order
 - Fourth Order
 - In Building
 - call other values>
- Shelters**
- Shelters
 - Shelters
- Cabinets**
- Cabinets
- Vault/Handholes**
- Pedestrian Rated**
- Unknown Size (Pedestrian)
 - HH 0 (12x12 or eq.)
 - HH 1 (16x14 or eq.)
 - HH 2 (16x20 or eq.)
 - HH 3 (16x30 or eq.)
 - HH 4 (24x18 or eq.)
 - HH 5 (24x30 or eq.)
 - HH 6 (24x36 or eq.)
- Tier 15 Rated**
- Unknown Size (Tier Rated)
 - HH 1 (12x12 or eq.)
 - HH 1 (16x14 or eq.)
 - HH 2 (16x20 or eq.)
 - HH 3 (16x30 or eq.)
 - HH 4 (24x18 or eq.)
 - HH 5 (24x30 or eq.)
 - HH 6 (24x36 or eq.)
 - HH 7 (36x30 or eq.)
 - HH 8 (36x48 or eq.)
 - HH 9 (36x60 or eq.)
 - HH 10 (48x36 or eq.)
 - HH 11 (48x48 or eq.)
 - HH 12 (48x60 or eq.)
 - HH 13 (48x72 or eq.)
 - HH 14 (60x48 or eq.)
 - HH 15 (60x60 or eq.)
 - HH 16 (60x72 or eq.)
 - HH 17 (72x48 or eq.)
 - HH 18 (72x60 or eq.)
 - HH 19 (72x72 or eq.)
 - HH 20 (72x84 or eq.)
 - HH 21 (84x72 or eq.)
 - HH 22 (84x84 or eq.)
 - HH 23 (84x96 or eq.)
 - HH 24 (96x84 or eq.)
 - HH 25 (96x96 or eq.)
 - HH 26 (96x108 or eq.)
 - HH 27 (108x96 or eq.)
 - HH 28 (108x108 or eq.)
 - HH 29 (108x120 or eq.)
 - HH 30 (120x108 or eq.)
 - HH 31 (120x120 or eq.)
 - HH 32 (120x144 or eq.)
 - HH 33 (144x120 or eq.)
 - HH 34 (144x144 or eq.)
 - HH 35 (144x168 or eq.)
 - HH 36 (168x144 or eq.)
 - HH 37 (168x168 or eq.)
 - HH 38 (168x192 or eq.)
 - HH 39 (192x168 or eq.)
 - HH 40 (192x192 or eq.)
 - HH 41 (192x216 or eq.)
 - HH 42 (216x192 or eq.)
 - HH 43 (216x216 or eq.)
 - HH 44 (216x252 or eq.)
 - HH 45 (252x216 or eq.)
 - HH 46 (252x252 or eq.)
 - HH 47 (252x288 or eq.)
 - HH 48 (288x252 or eq.)
 - HH 49 (288x288 or eq.)
 - HH 50 (288x324 or eq.)
 - HH 51 (324x288 or eq.)
 - HH 52 (324x324 or eq.)
 - HH 53 (324x360 or eq.)
 - HH 54 (360x324 or eq.)
 - HH 55 (360x360 or eq.)
 - HH 56 (360x408 or eq.)
 - HH 57 (408x360 or eq.)
 - HH 58 (408x408 or eq.)
 - HH 59 (408x456 or eq.)
 - HH 60 (456x408 or eq.)
 - HH 61 (456x456 or eq.)
 - HH 62 (456x504 or eq.)
 - HH 63 (504x456 or eq.)
 - HH 64 (504x504 or eq.)
 - HH 65 (504x552 or eq.)
 - HH 66 (552x504 or eq.)
 - HH 67 (552x552 or eq.)
 - HH 68 (552x600 or eq.)
 - HH 69 (600x552 or eq.)
 - HH 70 (600x600 or eq.)
 - HH 71 (600x648 or eq.)
 - HH 72 (648x600 or eq.)
 - HH 73 (648x648 or eq.)
 - HH 74 (648x708 or eq.)
 - HH 75 (708x648 or eq.)
 - HH 76 (708x708 or eq.)
 - HH 77 (708x768 or eq.)
 - HH 78 (768x708 or eq.)
 - HH 79 (768x768 or eq.)
 - HH 80 (768x816 or eq.)
 - HH 81 (816x768 or eq.)
 - HH 82 (816x816 or eq.)
 - HH 83 (816x864 or eq.)
 - HH 84 (864x816 or eq.)
 - HH 85 (864x864 or eq.)
 - HH 86 (864x912 or eq.)
 - HH 87 (912x864 or eq.)
 - HH 88 (912x912 or eq.)
 - HH 89 (912x960 or eq.)
 - HH 90 (960x912 or eq.)
 - HH 91 (960x960 or eq.)
 - HH 92 (960x1008 or eq.)
 - HH 93 (1008x960 or eq.)
 - HH 94 (1008x1008 or eq.)
 - HH 95 (1008x1056 or eq.)
 - HH 96 (1056x1008 or eq.)
 - HH 97 (1056x1056 or eq.)
 - HH 98 (1056x1104 or eq.)
 - HH 99 (1104x1056 or eq.)
 - HH 100 (1104x1104 or eq.)
 - HH 101 (1104x1152 or eq.)
 - HH 102 (1152x1104 or eq.)
 - HH 103 (1152x1152 or eq.)
 - HH 104 (1152x1200 or eq.)
 - HH 105 (1200x1152 or eq.)
 - HH 106 (1200x1200 or eq.)
 - HH 107 (1200x1248 or eq.)
 - HH 108 (1248x1200 or eq.)
 - HH 109 (1248x1248 or eq.)
 - HH 110 (1248x1296 or eq.)
 - HH 111 (1296x1248 or eq.)
 - HH 112 (1296x1296 or eq.)
 - HH 113 (1296x1344 or eq.)
 - HH 114 (1344x1296 or eq.)
 - HH 115 (1344x1344 or eq.)
 - HH 116 (1344x1392 or eq.)
 - HH 117 (1392x1344 or eq.)
 - HH 118 (1392x1392 or eq.)
 - HH 119 (1392x1440 or eq.)
 - HH 120 (1440x1392 or eq.)
 - HH 121 (1440x1440 or eq.)
 - HH 122 (1440x1488 or eq.)
 - HH 123 (1488x1440 or eq.)
 - HH 124 (1488x1488 or eq.)
 - HH 125 (1488x1536 or eq.)
 - HH 126 (1536x1488 or eq.)
 - HH 127 (1536x1536 or eq.)
 - HH 128 (1536x1584 or eq.)
 - HH 129 (1584x1536 or eq.)
 - HH 130 (1584x1584 or eq.)
 - HH 131 (1584x1632 or eq.)
 - HH 132 (1632x1584 or eq.)
 - HH 133 (1632x1632 or eq.)
 - HH 134 (1632x1680 or eq.)
 - HH 135 (1680x1632 or eq.)
 - HH 136 (1680x1680 or eq.)
 - HH 137 (1680x1728 or eq.)
 - HH 138 (1728x1680 or eq.)
 - HH 139 (1728x1728 or eq.)
 - HH 140 (1728x1776 or eq.)
 - HH 141 (1776x1728 or eq.)
 - HH 142 (1776x1776 or eq.)
 - HH 143 (1776x1824 or eq.)
 - HH 144 (1824x1776 or eq.)
 - HH 145 (1824x1824 or eq.)
 - HH 146 (1824x1872 or eq.)
 - HH 147 (1872x1824 or eq.)
 - HH 148 (1872x1872 or eq.)
 - HH 149 (1872x1920 or eq.)
 - HH 150 (1920x1872 or eq.)
 - HH 151 (1920x1920 or eq.)
 - HH 152 (1920x1968 or eq.)
 - HH 153 (1968x1920 or eq.)
 - HH 154 (1968x1968 or eq.)
 - HH 155 (1968x2016 or eq.)
 - HH 156 (2016x1968 or eq.)
 - HH 157 (2016x2016 or eq.)
 - HH 158 (2016x2064 or eq.)
 - HH 159 (2064x2016 or eq.)
 - HH 160 (2064x2064 or eq.)
 - HH 161 (2064x2112 or eq.)
 - HH 162 (2112x2064 or eq.)
 - HH 163 (2112x2112 or eq.)
 - HH 164 (2112x2160 or eq.)
 - HH 165 (2160x2112 or eq.)
 - HH 166 (2160x2160 or eq.)
 - HH 167 (2160x2208 or eq.)
 - HH 168 (2208x2160 or eq.)
 - HH 169 (2208x2208 or eq.)
 - HH 170 (2208x2256 or eq.)
 - HH 171 (2256x2208 or eq.)
 - HH 172 (2256x2256 or eq.)
 - HH 173 (2256x2304 or eq.)
 - HH 174 (2304x2256 or eq.)
 - HH 175 (2304x2304 or eq.)
 - HH 176 (2304x2352 or eq.)
 - HH 177 (2352x2304 or eq.)
 - HH 178 (2352x2352 or eq.)
 - HH 179 (2352x2400 or eq.)
 - HH 180 (2400x2352 or eq.)
 - HH 181 (2400x2400 or eq.)
 - HH 182 (2400x2448 or eq.)
 - HH 183 (2448x2400 or eq.)
 - HH 184 (2448x2448 or eq.)
 - HH 185 (2448x2496 or eq.)
 - HH 186 (2496x2448 or eq.)
 - HH 187 (2496x2496 or eq.)
 - HH 188 (2496x2544 or eq.)
 - HH 189 (2544x2496 or eq.)
 - HH 190 (2544x2544 or eq.)
 - HH 191 (2544x2592 or eq.)
 - HH 192 (2592x2544 or eq.)
 - HH 193 (2592x2592 or eq.)
 - HH 194 (2592x2640 or eq.)
 - HH 195 (2640x2592 or eq.)
 - HH 196 (2640x2640 or eq.)
 - HH 197 (2640x2688 or eq.)
 - HH 198 (2688x2640 or eq.)
 - HH 199 (2688x2688 or eq.)
 - HH 200 (2688x2736 or eq.)
 - HH 201 (2736x2688 or eq.)
 - HH 202 (2736x2736 or eq.)
 - HH 203 (2736x2784 or eq.)
 - HH 204 (2784x2736 or eq.)
 - HH 205 (2784x2784 or eq.)
 - HH 206 (2784x2832 or eq.)
 - HH 207 (2832x2784 or eq.)
 - HH 208 (2832x2832 or eq.)
 - HH 209 (2832x2880 or eq.)
 - HH 210 (2880x2832 or eq.)
 - HH 211 (2880x2880 or eq.)
 - HH 212 (2880x2928 or eq.)
 - HH 213 (2928x2880 or eq.)
 - HH 214 (2928x2928 or eq.)
 - HH 215 (2928x2976 or eq.)
 - HH 216 (2976x2928 or eq.)
 - HH 217 (2976x2976 or eq.)
 - HH 218 (2976x3024 or eq.)
 - HH 219 (3024x2976 or eq.)
 - HH 220 (3024x3024 or eq.)
 - HH 221 (3024x3072 or eq.)
 - HH 222 (3072x3024 or eq.)
 - HH 223 (3072x3072 or eq.)
 - HH 224 (3072x3120 or eq.)
 - HH 225 (3120x3072 or eq.)
 - HH 226 (3120x3120 or eq.)
 - HH 227 (3120x3168 or eq.)
 - HH 228 (3168x3120 or eq.)
 - HH 229 (3168x3168 or eq.)
 - HH 230 (3168x3216 or eq.)
 - HH 231 (3216x3168 or eq.)
 - HH 232 (3216x3216 or eq.)
 - HH 233 (3216x3264 or eq.)
 - HH 234 (3264x3216 or eq.)
 - HH 235 (3264x3264 or eq.)
 - HH 236 (3264x3312 or eq.)
 - HH 237 (3312x3264 or eq.)
 - HH 238 (3312x3312 or eq.)
 - HH 239 (3312x3360 or eq.)
 - HH 240 (3360x3312 or eq.)
 - HH 241 (3360x3360 or eq.)
 - HH 242 (3360x3408 or eq.)
 - HH 243 (3408x3360 or eq.)
 - HH 244 (3408x3408 or eq.)
 - HH 245 (3408x3456 or eq.)
 - HH 246 (3456x3408 or eq.)
 - HH 247 (3456x3456 or eq.)
 - HH 248 (3456x3504 or eq.)
 - HH 249 (3504x3456 or eq.)
 - HH 250 (3504x3504 or eq.)
 - HH 251 (3504x3552 or eq.)
 - HH 252 (3552x3504 or eq.)
 - HH 253 (3552x3552 or eq.)
 - HH 254 (3552x3600 or eq.)
 - HH 255 (3600x3552 or eq.)
 - HH 256 (3600x3600 or eq.)
 - HH 257 (3600x3648 or eq.)
 - HH 258 (3648x3600 or eq.)
 - HH 259 (3648x3648 or eq.)
 - HH 260 (3648x3696 or eq.)
 - HH 261 (3696x3648 or eq.)
 - HH 262 (3696x3696 or eq.)
 - HH 263 (3696x3744 or eq.)
 - HH 264 (3744x3696 or eq.)
 - HH 265 (3744x3744 or eq.)
 - HH 266 (3744x3792 or eq.)
 - HH 267 (3792x3744 or eq.)
 - HH 268 (3792x3792 or eq.)
 - HH 269 (3792x3840 or eq.)
 - HH 270 (3840x3792 or eq.)
 - HH 271 (3840x3840 or eq.)
 - HH 272 (3840x3888 or eq.)
 - HH 273 (3888x3840 or eq.)
 - HH 274 (3888x3888 or eq.)
 - HH 275 (3888x3936 or eq.)
 - HH 276 (3936x3888 or eq.)
 - HH 277 (3936x3936 or eq.)
 - HH 278 (3936x3984 or eq.)
 - HH 279 (3984x3936 or eq.)
 - HH 280 (3984x3984 or eq.)
 - HH 281 (3984x4032 or eq.)
 - HH 282 (4032x3984 or eq.)
 - HH 283 (4032x4032 or eq.)
 - HH 284 (4032x4080 or eq.)
 - HH 285 (4080x4032 or eq.)
 - HH 286 (4080x4080 or eq.)
 - HH 287 (4080x4128 or eq.)
 - HH 288 (4128x4080 or eq.)
 - HH 289 (4128x4128 or eq.)
 - HH 290 (4128x4176 or eq.)
 - HH 291 (4176x4128 or eq.)
 - HH 292 (4176x4176 or eq.)
 - HH 293 (4176x4224 or eq.)
 - HH 294 (4224x4176 or eq.)
 - HH 295 (4224x4224 or eq.)
 - HH 296 (4224x4272 or eq.)
 - HH 297 (4272x4224 or eq.)
 - HH 298 (4272x4272 or eq.)
 - HH 299 (4272x4320 or eq.)
 - HH 300 (4320x4272 or eq.)
 - HH 301 (4320x4320 or eq.)
 - HH 302 (4320x4368 or eq.)
 - HH 303 (4368x4320 or eq.)
 - HH 304 (4368x4368 or eq.)
 - HH 305 (4368x4416 or eq.)
 - HH 306 (4416x4368 or eq.)
 - HH 307 (4416x4416 or eq.)
 - HH 308 (4416x4464 or eq.)
 - HH 309 (4464x4416 or eq.)
 - HH 310 (4464x4464 or eq.)
 - HH 311 (4464x4512 or eq.)
 - HH 312 (4512x4464 or eq.)
 - HH 313 (4512x4512 or eq.)
 - HH 314 (4512x4560 or eq.)
 - HH 315 (4560x4512 or eq.)
 - HH 316 (4560x4560 or eq.)
 - HH 317 (4560x4608 or eq.)
 - HH 318 (4608x4560 or eq.)
 - HH 319 (4608x4608 or eq.)
 - HH 320 (4608x4656 or eq.)
 - HH 321 (4656x4608 or eq.)
 - HH 322 (4656x4656 or eq.)
 - HH 323 (4656x4704 or eq.)
 - HH 324 (4704x4656 or eq.)
 - HH 325 (4704x4704 or eq.)
 - HH 326 (4704x4752 or eq.)
 - HH 327 (4752x4704 or eq.)
 - HH 328 (4752x4752 or eq.)
 - HH 329 (4752x4800 or eq.)
 - HH 330 (4800x4752 or eq.)
 - HH 331 (4800x4800 or eq.)
 - HH 332 (4800x4848 or eq.)
 - HH 333 (4848x4800 or eq.)
 - HH 334 (4848x4848 or eq.)
 - HH 335 (4848x4896 or eq.)
 - HH 336 (4896x4848 or eq.)
 - HH 337 (4896x4896 or eq.)
 - HH 338 (4896x4944 or eq.)
 - HH 339 (4944x4896 or eq.)
 - HH 340 (4944x4944 or eq.)
 - HH 341 (4944x4992 or eq.)
 - HH 342 (4992x4944 or eq.)
 - HH 343 (4992x4992 or eq.)
 - HH 344 (4992x5040 or eq.)
 - HH 345 (5040x4992 or eq.)
 - HH 346 (5040x5040 or eq.)
 - HH 347 (5040x5088 or eq.)
 - HH 348 (5088x5040 or eq.)
 - HH 349 (5088x5088 or eq.)
 - HH 350 (5088x5136 or eq.)
 - HH 351 (5136x5088 or eq.)
 - HH 352 (5136x5136 or eq.)
 - HH 353 (5136x5184 or eq.)
 - HH 354 (5184x5136 or eq.)
 - HH 355 (5184x5184 or eq.)
 - HH 356 (5184x5232 or eq.)
 - HH 357 (5232x5184 or eq.)
 - HH 358 (5232x5232 or eq.)
 - HH 359 (5232x5280 or eq.)
 - HH 360 (5280x5232 or eq.)
 - HH 361 (5280x5280 or eq.)
 - HH 362 (5280x5328 or eq.)
 - HH 363 (5328x5280 or eq.)
 - HH 364 (5328x5328 or eq.)
 - HH 365 (5328x5376 or eq.)
 - HH 366 (5376x5328 or eq.)
 - HH 367 (5376x5376 or eq.)
 - HH 368 (5376x5424 or eq.)
 - HH 369 (5424x5376 or eq.)
 - HH 370 (5424x5424 or eq.)
 - HH 371 (5424x5472 or eq.)
 - HH 372 (5472x5424 or eq.)
 - HH 373 (5472x5472 or eq.)
 - HH 374 (5472x5520 or eq.)
 - HH 375 (5520x5472 or eq.)
 - HH 376 (5520x5520 or eq.)
 - HH 377 (5520x5568 or eq.)
 - HH 378 (5568x5520 or eq.)
 - HH 379 (5568x5568 or eq.)
 - HH 380 (5568x5616 or eq.)
 - HH 381 (5616x5568 or eq.)
 - HH 382 (5616x5616 or eq.)
 - HH 383 (5616x5664 or eq.)
 - HH 384 (5664x5616 or eq.)
 - HH 385 (5664x5664 or eq.)
 - HH 386 (5664x5712 or eq.)
 - HH 387 (5712x5664 or eq.)
 - HH 388 (5712x5712 or eq.)
 - HH 389 (5712x5760 or eq.)
 - HH 390 (5760x5712 or eq.)
 - HH 391 (5760x5760 or eq.)
 - HH 392 (5760x5808 or eq.)
 - HH 393 (5808x5760 or eq.)
 - HH 394 (5808x5808 or eq.)
 - HH 395 (5808x5856 or eq.)
 - HH 396 (5856x5808 or eq.)
 - HH 397 (5856x5856 or eq.)
 - HH 398 (5856x5904 or eq.)
 - HH 399 (5904x5856 or eq.)
 - HH 400 (5904x5904 or eq.)
 - HH 401 (5904x5952 or eq.)
 - HH 402 (5952x5904 or eq.)
 - HH 403 (5952x5952 or eq.)
 - HH 404 (5952x6000 or eq.)
 - HH 405 (6000x5952 or eq.)
 - HH 406 (6000x6000 or eq.)
 - HH 407 (6000x6048 or eq.)
 - HH 408 (6048x6000 or eq.)
 - HH 409 (6048x6048 or eq.)
 - HH 410 (6048x6096 or eq.)
 - HH 411 (6096x6048 or eq.)
 - HH 412 (6096x6096 or eq.)
 - HH 413 (6096x6144 or eq.)
 - HH 414 (6144x6096 or eq.)
 - HH 415 (6144x6144 or eq.)
 - HH 416 (6144x6192 or eq.)
 - HH 417 (6192x6144 or eq.)
 - HH 418 (6192x6192 or eq.)
 - HH 419 (6192x6240 or eq.)
 - HH 420 (6240x6192 or eq.)
 - HH 421 (6240x6240 or eq.)
 - HH 422 (6240x6288 or eq.)
 - HH 423 (6288x6240 or eq.)
 - HH 424 (6288x6288 or eq.)
 - HH 425 (6288x6336 or eq.)
 - HH 426 (6336x6288 or eq.)
 - HH 427 (6336x6336 or eq.)
 - HH 428 (6336x6384 or eq.)
 - HH 429 (6384x6336 or eq.)
 - HH 430 (6384x6384 or eq.)
 - HH 431 (6384x6432 or eq.)
 - HH 432 (6432x6384 or eq.)
 - HH 433 (6432x6432 or eq.)
 - HH 434 (6432x6480 or eq.)
 - HH 435 (6480x6432 or eq.)
 - HH 436 (6480x6480 or eq.)
 - HH 437 (6480x6528 or eq.)
 - HH 438 (6528x6480 or eq.)
 - HH 439 (6528x6528 or eq.)
 - HH 440 (6528x6576 or eq.)
 - HH 441 (6576x6528 or eq.)
 - HH 442 (6576x6576 or eq.)
 - HH 443 (6576x6624 or eq.)
 - HH 444 (6624x6576 or eq.)
 - HH 445 (6624x6624 or eq.)
 - HH 446 (6624x6672 or eq.)
 - HH 447 (6672x6624 or eq.)
 - HH 448 (6672x6672 or eq.)
 - HH 449 (6672x6720 or eq.)
 - HH 450 (6720x6672 or eq.)
 - HH 451 (6720x6720 or eq.)
 - HH 452 (6720x6768 or eq.)
 - HH 453 (6768x6720 or eq.)
 - HH 454 (6768x6768 or eq.)
 - HH 455 (6768x6816 or eq.)
 - HH 456 (6816x6768 or eq.)
 - HH 457 (6816x6816 or eq.)
 - HH 458 (6816x6864 or eq.)
 - HH 459 (6864x6816 or eq.)
 - HH 460 (6864x6864 or eq.)
 - HH 461 (6864x6912 or eq.)
 - HH 462 (6912x6864 or eq.)
 - HH 463 (6912x6912 or eq.)
 - HH 464 (6912x6960 or eq.)
 - HH 465 (6960x6912 or eq.)
 - HH 466 (6960x6960 or eq.)
 - HH 467 (6960x7008 or eq.)
 - HH 468 (7008x6960 or eq.)
 - HH 469 (7008x7008 or eq.)
 - HH 470 (7008x7056 or eq.)
 - HH 471 (7056x7008 or eq.)
 - HH 472 (7056x7056 or eq.)
 - HH 473 (7056x7104 or eq.)
 - HH 474 (7104x7056 or eq.)
 - HH 475 (7104x7104 or eq.)
 - HH 476 (7104x7152 or eq.)
 - HH 477 (7152x7104 or eq.)
 - HH 478 (7152x7152 or eq.)
 - HH 479 (7152x7200 or eq.)
 - HH 480 (7200x7152 or eq.)
 - HH 481 (7200x7200 or eq.)
 - HH 482 (7200x7248 or eq.)
 - HH 483 (7248x7200 or eq.)
 - HH 484 (7248x7248 or eq.)
 - HH 485 (7248x7296 or eq.)
 - HH 486 (7296x7248 or eq.)
 - HH 487 (7296x7296 or eq.)
 - HH 488 (7296x7344 or eq.)
 - HH 489 (7344x7296 or eq.)
 - HH 490 (7344x7344 or eq.)
 - HH 491 (7344x7392 or eq.)
 - HH 492 (7392x7344 or eq.)
 - HH 493 (7392x7392 or eq.)
 - HH 494 (7392x7440 or eq.)
 - HH 495 (7440x7392 or eq.)
 - HH 496 (7440x7440 or eq.)
 - HH 497 (7440x7488 or eq.)
 - HH 498 (7488x7440 or eq.)
 - HH 499 (7488x7488 or eq.)
 - HH 500 (7488x7536 or eq.)
 - HH 501 (7536x7488 or eq.)
 - HH 502 (7536x7536 or eq.)
 - HH 503 (7536x7584 or eq.)
 - HH 504 (7584x7536 or eq.)
 - HH 505 (7584x7584 or eq.)
 - HH 506 (7584x7632 or eq.)
 - HH 50

PROJECT ENGINEER:	Steven Berthold
REVISIONS	
/ 24 No.	
/ 24 No.	
/ 24 No.	
/ 24 No.	
/ 24 No.	

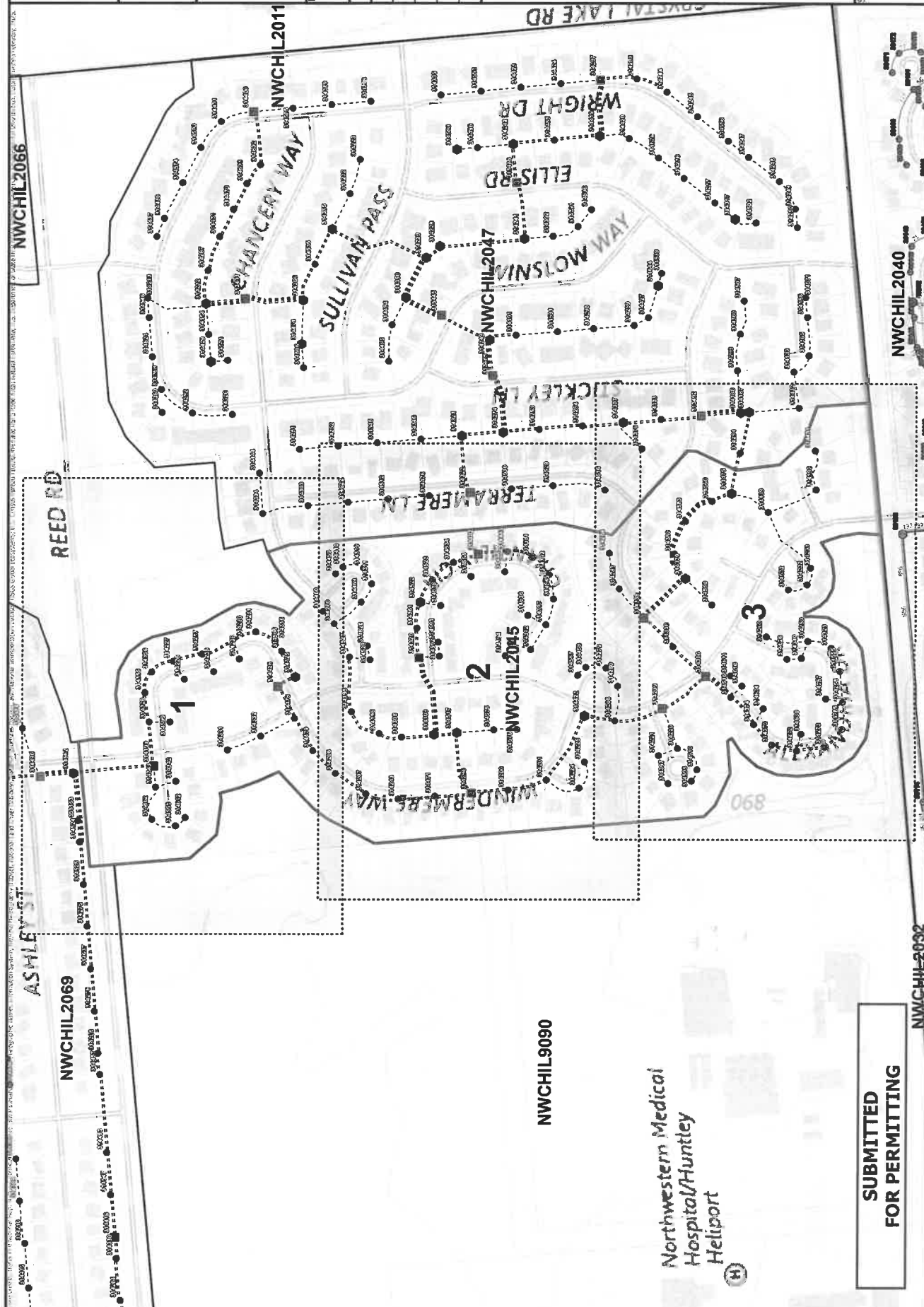

SUBMITTED FOR PERMITTING

NWCCHIL-2092



SHEET NOTES:
 1. See Sheet 07 for typical road crossing and bore pit details.
 2. Method of conduit installation shall be determined by the contractor. ALL WORK SHALL BE IN ACCORDANCE WITH THE ILLINOIS SPECIAL PERMITTING COMMITMENTS (See Sheet 04).
 3. Additional conduit locations (other than those shown) shall be determined by the contractor. ALL ADDITIONAL SIZES SHALL FOLLOW THE SAME GENERAL BORE-PATH AS THE PRIMARY DUCT.

PROJECT ENGINEER:
 Steven Berchold

REVISIONS	
/	/ 24 No.
/	/ 24 No.
/	/ 24 No.
/	/ 24 No.
/	/ 24 No.

PROPOSED FIBER INSTALLATION PLANS
FIBER INSTALLATION PLAN MAPS
 Printed: 4/10/2025
 Time: 12:30 PM

SECTOR: NWCHIL2045

SHEET: **D1**



**Facilities leaving project boundaries shown only for reference.
 Only facilities entirely inside of project boundaries to be considered part of the project scope unless otherwise specified.**

SUBMITTED FOR PERMITTING

REVISIONS	
/ 24	No.
/ 24	No.
/ 24	No.
/ 24	No.
/ 24	No.

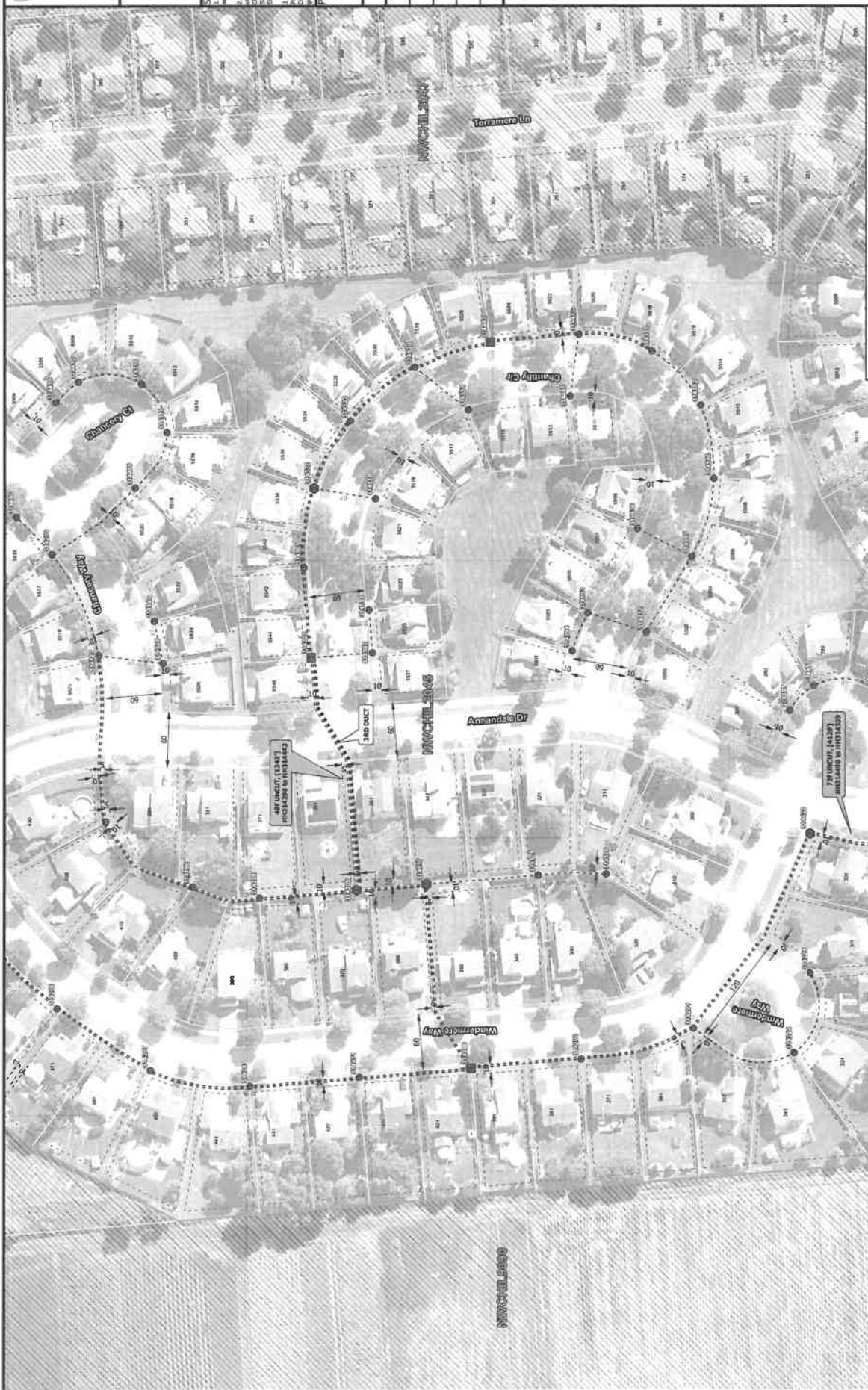

Facilities leaving project boundaries shown only for reference. Only facilities entirely inside of project boundaries to be considered part of the project scope unless otherwise specified.

SUBMITTED FOR PERMITTING

REVISIONS	
/ 724 No.	
/ 724 No.	
/ 724 No.	
/ 724 No.	
/ 724 No.	



**Facilities leaving project boundaries shown only for reference.
 Only facilities entirely inside of project boundaries to be considered part of the project scope unless otherwise specified.**

SUBMITTED FOR PERMITTING

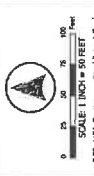

SHEET NOTES:
 1. Fiber routes shown are for reference only. Final route shall be determined by field verification and field representation ONLY. Fiber shall be installed within proposed conduit.
 2. Contractor shall verify all dimensions prior to installing fiber ducts.
 3. See Sheet N1 for finished floor cable slack requirement.

PROJECT ENGINEER:
 Steven Berchtold

REVISIONS

/	/ 24	No.
/	/ 24	No.
/	/ 24	No.
/	/ 24	No.

PROPOSED FIBER INSTALLATION PLANS
FIBER INSTALLATION PLAN MAPS
 Printed: 4/10/2025
 Time: 12:40 PM

SECTOR: NWCHIL2045

SHEET:

F1

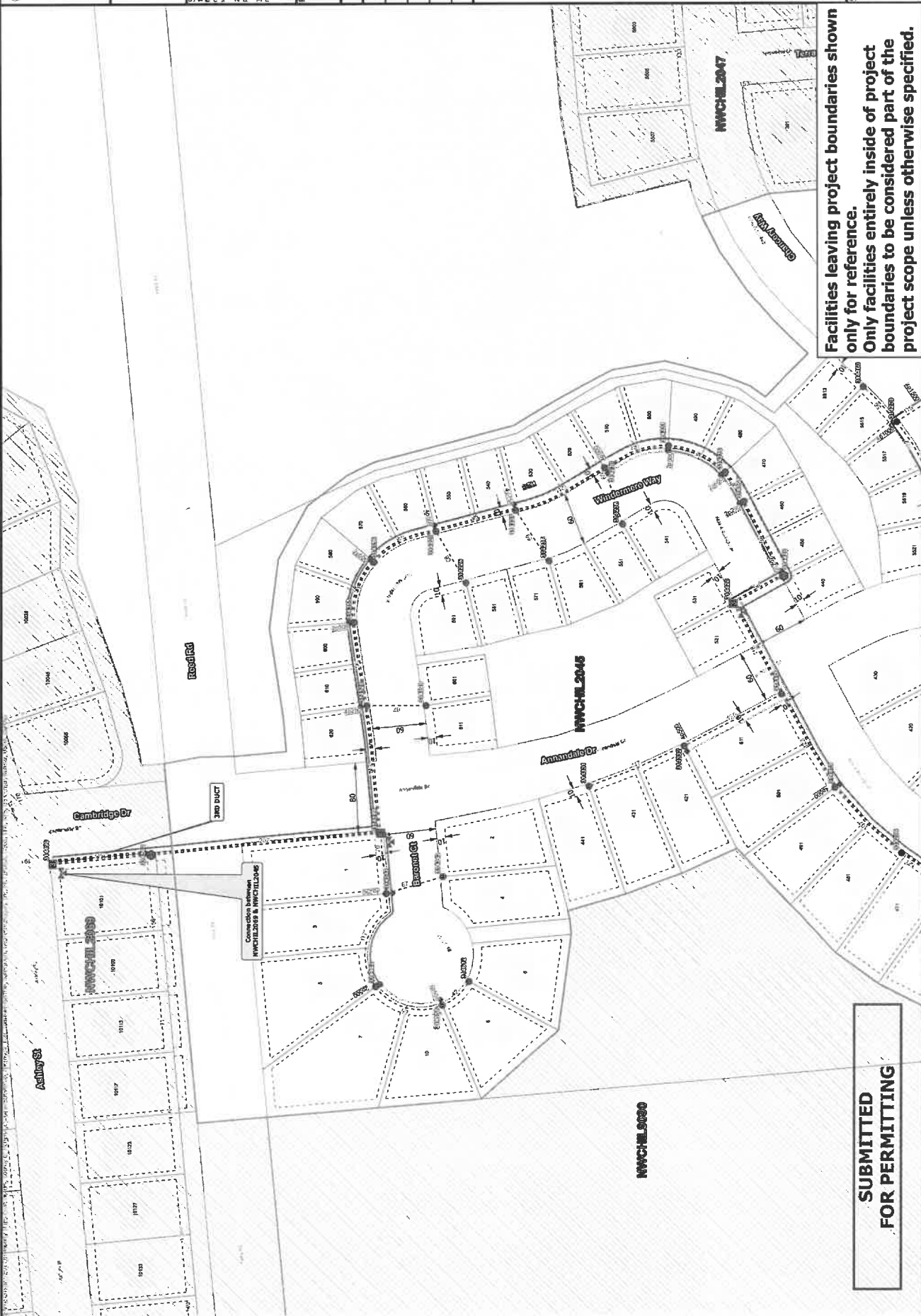

Facilities leaving project boundaries shown only for reference. Only facilities entirely inside of project boundaries to be considered part of the project scope unless otherwise specified.

SUBMITTED FOR PERMITTING



SHEET NOTES:
 1. Fiber cables and loops are shown as offset from proposed conduit for cartographic clarity. They shall be installed when proposed conduit.
 2. Contractor shall field verify all dimensions prior to installing fiber cable.
 3. See Sheet M1 for installed fiber cable book requirements.

PROJECT ENGINEER: Steven Berthold

REVISIONS	
/ 24 No.	
/ 24 No.	
/ 24 No.	
/ 24 No.	
/ 24 No.	

PROPOSED FIBER INSTALLATION PLANS
FIBER INSTALLATION PLAN MAPS
 Printed: 4/10/2025
 Time: 12:41 PM

SECTOR: NWCHIL2045

SHEET: **F2**

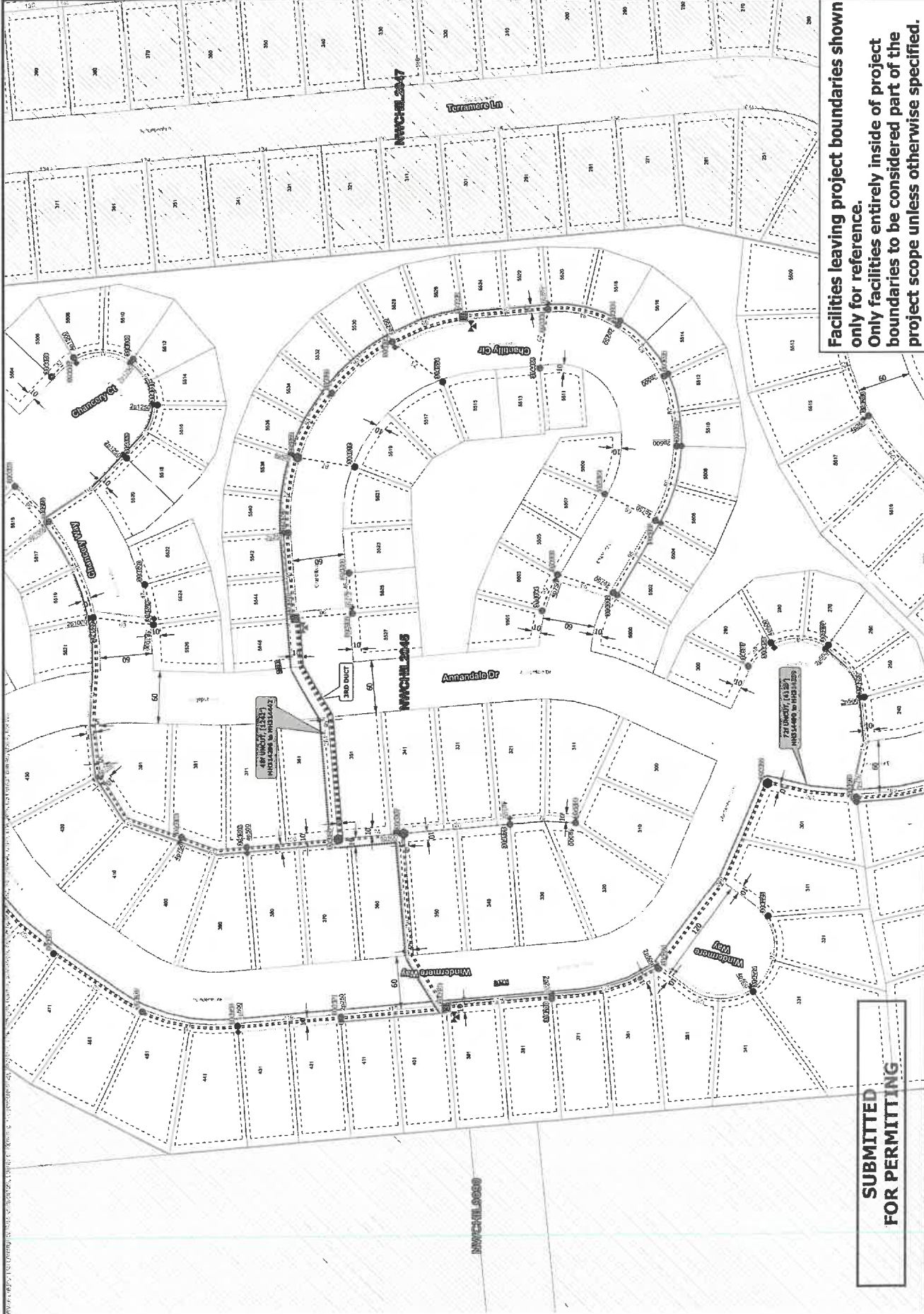

**Facilities leaving project boundaries shown only for reference.
 Only facilities entirely inside of project boundaries to be considered part of the project scope unless otherwise specified.**

SUBMITTED FOR PERMITTING

\\P01\apps\proj\i3broadband\sector\proj\i3broadband\NWCHIL2045\F2_Template.apr

